

Aluminium alloy grilles MRA

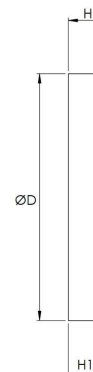
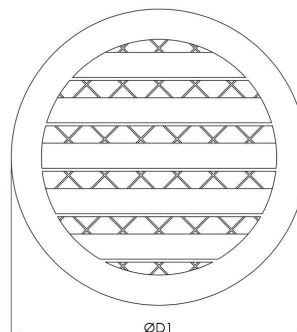
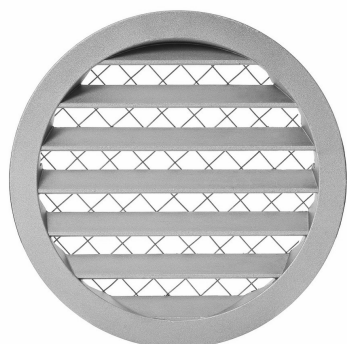

Description

Aluminium alloy grilles for supply and exhaust ventilation equipped with mesh.

Technical data

Construction	Made from aluminium alloy Stainless steel wire mesh
Installation	Screw fixing in any position
Colors	Metallic, white, anthracite, beige, grey, black, brown

Dimensions

Type	D [mm]	D1 [mm]	H [mm]	H1 [mm]	Mesh [mm x mm] ±2mm	Air pass [m ²]	m [kg]
MRA80	80	97	15	11	10x10	0,0028	0,082
MRA100	100	124	20	17	10x10	0,0044	0,126
MRA125	125	151	19	16	10x10	0,0068	0,185
MRA160	160	182	19	14	14x14	0,0120	0,260
MRA200	200	224	20	16	14x14	0,0200	0,372
MRA250	250	276	21	16	14x14	0,0310	0,767
MRA315	315	346	21	14	14x14	0,0470	1,310

Modifications

- MRAxxx – unpainted
- MRAxxxA - anthracite color polymer coating
- MRAxxxY – beige RAL1015 polymer coating
- MRAxxxP – grey RAL9006 polymer coating
- MRAxxxM – black RAL9005 polymer coating
- MRAxxxB – brown RAL8016 polymer coating
- MRAxxxW – white RAL9016 polymer coating
- MRAxxx-1 – equipped with ~2x2mm mesh